

3-PC Casting Ball Valve Full Port, Direct Mount, 1000 WOG, High Performance

KV-L30, KV-L31, KV-L31-L, KV-L32, KV-L3F (Direct Mount Type)

FEATURES:

- Built-in ISO 5211 Direct Mounting Pad and Square Stem for Easy Automation
- Anti-Static Devices for Ball-Stem-Body
- Blow-out Proof Stem
- Pressure Balance Hole in Ball Slot
- Pre-Load 2 Belleville Washers to Self-adjust Packing
- **TA-LUFT** Design Approved
- Options: 1. Actuator 2. Limit Switch 3. Positioner

STANDARDS:

- Design: MSS SP-110
- Wall Thickness: EN 12516-3
- Pipe Thread **KV-L30**: ASME B1.20.1
DIN 2999 / 259, ISO 228 / 1
JIS B 0203, ISO 7 / 1
- Butt Weld **KV-L31**: ASME B16.25 (ØB2 Sch 40)
- Extended Butt Weld **KV-L31-L**: ASME B16.25 (ØB2 Sch 40)
- Socket Weld **KV-L32**: ASME B16.11
- Flanged Ends **KV-L3F** :
KV-L3F(1) : ASME CLASS 150, KV-L3F(2) : ASME CLASS 300
KV-L3F(J) : PN10, KV-L3F(K) : PN16, KV-L3F(M) : PN25, KV-L3F(N) : PN40 EN 1092-1
KV-L3F(A) : JIS 10K, KV-L3F(C) : JIS 20K B 2220
- Inspection & Testing: MSS SP-110

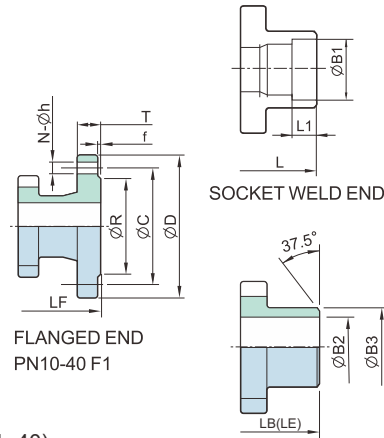

LB (Butt-welding Ends)
LE (Extended Butt-welding Ends)

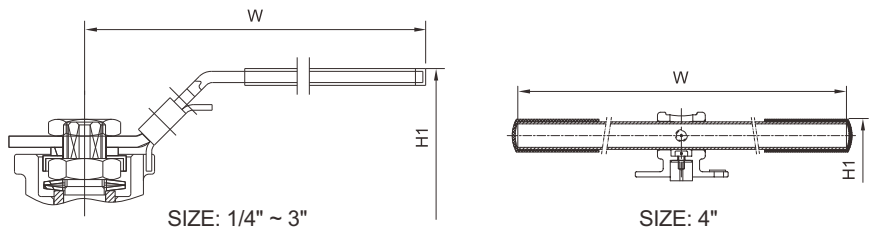
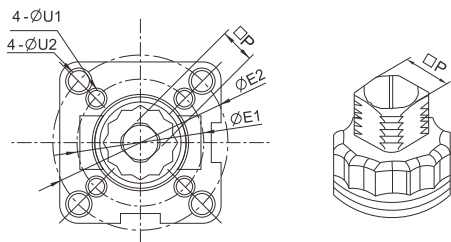

NO.	PART NAME	MATERIALS		
1	Body	CF8M	CF8	WCB
2	Cap (Thread)	CF8M	CF8	WCB
	Cap (Welding)	CF3M	CF3	
3	Ball	CF8M	CF8	
4	Ball Seat	TFM 1600 / PTFE / RTFE		
5	Stem	316	304	
6	Anti-Static Device	316	304	
7	Thrust Washer		PTFE	
8	O-Ring		FKM	
9	Stem Packing		PTFE	
10	Bushing	50%SS+50%PTFE		
11	Gland	316		
12	Belleville Washer		301	
13	Stem Nut		A194-8	
14	Stop-Lock-Cap		304	
15	Bolting	A193-B8/A2-70		
16	Bolt Washer		304	
17	Bolt Nut	A194-8/A2-70		
18	Body Gasket		PTFE	
19	Hex Bolting	A2-70		
20	Actuator	Pneumatic KP / Electric KQ		

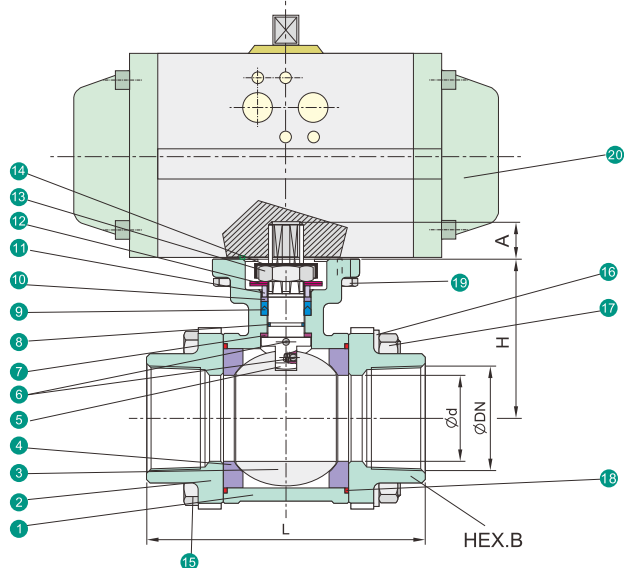

Unit: mm

SIZE	d	L	LB	LE	LF	H	H1	W	E1	E2	P	U1	U2	A	D	C	R	T	f	N	h	L1	B1	B2	B3	ISO 5211
1/4"	10.6	75	70	225	—	42.0	72	147	36	42	9	6	6	9	—	—	—	—	—	—	—	10	14.2	9.3	18	F03-F04
3/8"	12.7	75	70	225	—	42.0	72	147	36	42	9	6	6	9	—	—	—	—	—	—	—	10	17.8	12.5	18	F03-F04
1/2"	15.0	75	75	225	130	42.0	72	147	36	42	9	6	6	9	95	65	45	16	2	4	14	10	21.8	15.8	22	F03-F04
3/4"	20.0	80	90	225	150	48.5	79	147	36	50	9	6	7	9	105	75	58	18	2	4	14	13	27.3	20.9	28	F03-F05
1"	25.0	90	100	245	160	58.5	89	177	42	50	11	6	7	11	115	85	68	18	2	4	14	13	34.0	26.7	34	F04-F05
1-1/4"	32.0	110	110	255	180	63.0	93	177	42	70	11	6	9	11	140	100	78	18	2	4	18	16	42.8	35.1	43	F04-F07
1-1/2"	38.0	120	125	260	200	71.3	103	197	50	70	14	7	9	14	150	110	88	18	3	4	18	16	48.9	40.9	50	F05-F07
2"	50.0	140	150	275	230	78.2	110	197	50	70	14	7	9	14	165	125	102	20	3	4	18	17	61.4	52.5	61	F05-F07
2-1/2"	63.5	185	190	330	290	100.0	150	267	70	102	17	9	11	17	185	145	122	22	3	8	18	17	74.0	62.7	76	F07-F10
3"	76.0	205	220	356	310	108.5	159	267	70	102	17	9	11	17	200	160	138	24	3	8	18	17	90.0	78.0	92	F07-F10
4"	100.0	240	270	432	350	140.0	212	400	—	102	22	—	11	22	235	190	162	24	3	8	22	20	115.1	102.4	115	F10

*M3 Face to Face dimensions are available

3-PC Casting Ball Valve Full Port, Bracket Mount, 2000-1500 WOG, High Performance

KV-080, KV-081, KV-081-L, KV-082 (Bracket Mount Type)
KV-080F, KV-081F, KV-081F-L, KV-082F (Bracket Mount Type / Fire Safe Type)

FEATURES:

- **Fire Safe** Design Approved
- Built-in ISO 5211 Mounting Pad for Easy Automation
- **(Ex)** Anti-Static Devices for Ball-Stem-Body
- Blow-out Proof Stem
- Pressure Balance Hole in Ball Slot
- Pre-load 2 Belleville Washers to Self-adjust Packing
- Double Stem Sealing Acc. to TA-Luft
- Casting Approved by TÜV AD 2000 - Merkblatt W0
- **TA-LUFT** **ISO15848-1** Design Approved

APPLICABLE STANDARDS:

- Design : MSS SP-110
2000WOG for NPS^{1/4}~NPS1
1500WOG for NPS^{1/4}~NPS2
- Wall Thickness: EN 12516-3
- Fire Safe : API 607 5th 2005, ISO 10497
- Pipe Thread **KV - 080** : ASME B1.20.1
DIN 2999 / 259, ISO 228 / 1
JIS B 0203, ISO 7 / 1
- Butt Weld **KV-081**: ASME B16.25 (∅B2 Sch 80)
- Extended Butt Weld **KV-081-L**: ASME B16.25 (∅B2 Sch 80)
- Socket Weld **KV - 082** : ASME B16.11
- Inspection & Testing :MSS SP-110

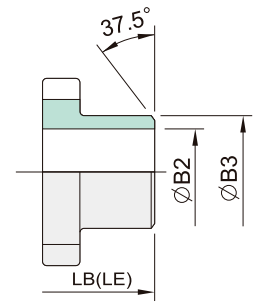
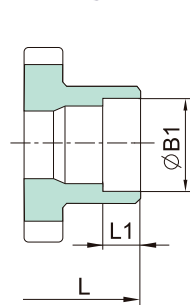
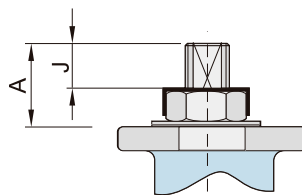
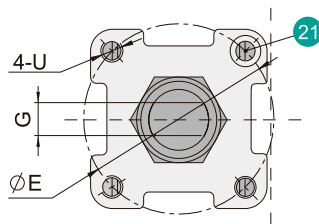

SOCKET WELD END

LB (Butt-welding Ends)

LE (Extended Butt-welding Ends)

NO.	PART NAME	MATERIALS		
1	Body	CF8M	CF8	WCB
2	Cap (Thread)	CF8M	CF8	WCB
	Cap (Welding)	CF3M	CF8	
3	Ball	CF8M	CF8	
4	Ball Seat	TFM4215		
5	Bolt	A193 - B8 / A2-70		
6	Stem	316	304	
7	Anti-Static Device	316	304	
8	Thrust Washer	PTFE		
9	O-ring	FKM		
10	Stem Packing	PTFE / GRAPHITE*		
11	Bushing	50%SS + 50%PTFE/ 304*		
12	Gland	316		
13	Belleville Washer	301		
14	Stem Nut	A194 - 8		
15	Stop-Lock-Cap	304		
16	Handle (NPS: 1/4~2)	304		
17	Handle Sleeve (NPS: 1/4~2)	Vinyl Plastic		
18	Locking Device (NPS: 1/4~2)	304		
19	Bolt Washer	304		
20	Bolt Nut	A194 - 8 / A2-70		
21	Stop Bolt	A2-70		
22	Body Gasket	PTFE / GRAPHITE*		

*Materials for FIRE-SAFE Models

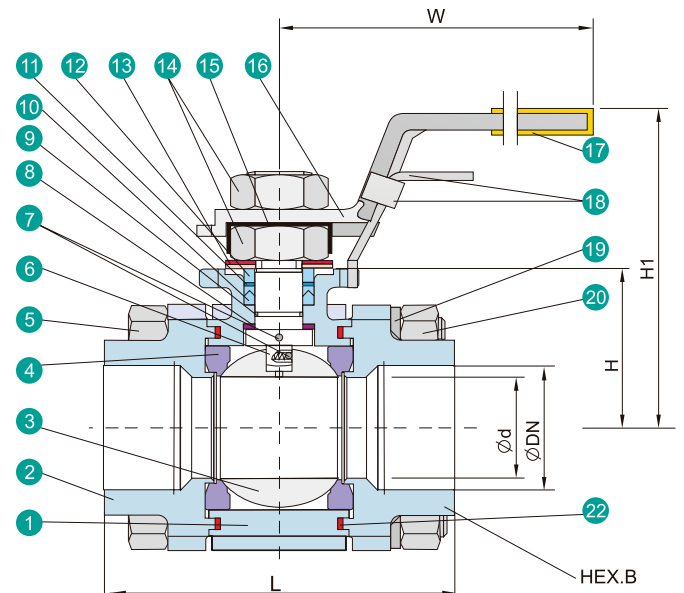

ANSI 2000WOG DIMENSION TABLE

DN	NPS	d	L	LS	LB	LE	H	H1	W	B1	B2	B3	L1	G	A	J	E	U	HEX.B	ISO 5211
8	1/4	10.6	75	70	70	165	43	73	147	14.2	7.6	18	10.0	6.3	17.3	10.4	42	M5	23.5	F04
10	3/8	12.7	75	70	70	165	43	73	147	17.6	10.7	18	10.0	6.3	17.3	10.4	42	M5	23.5	F04
15	1/2	15.0	75	75	75	165	43	73	147	21.8	13.9	22	10.0	6.3	20.3	11.8	42	M5	28.0	F04
20	3/4	20.0	80	80	90	190	51	81	147	27.2	18.8	28	13.0	6.3	20.3	11.8	42	M5	34.0	F04
25	1	25.0	90	90	100	216	58	88	177	33.9	24.3	34	13.0	9.0	23.3	12.5	50	M6	46.0	F05

ANSI 1500WOG DIMENSION TABLE

DN	NPS	d	L	LS	LB	LE	H	H1	W	B1	B2	B3	L1	G	A	J	E	U	HEX.B	ISO 5211
32	1 1/4	32.0	110	110	110	229	63	93	177	42.7	32.5	43	13.0	9.0	23.3	12.5	50	M6	55.0	F05
40	1 1/2	38.0	120	120	125	241	75	107	197	48.8	38.1	50	13.0	9.6	30.0	15.1	70	M8	57.0	F07
50	2	50.0	140	140	150	292	86	118	197	61.2	49.2	61	16.0	9.6	30.0	15.1	70	M8	73.0	F07